

## DVV Clarification Metric ID 7.1.4

### Index

S.No.	Document Description	
1	<b>Rain Water Harvesting</b>	
	<ul style="list-style-type: none"> <li>Description : The University has a well designed rain water harvesting system for collection of rain water. This system is spread in an area of approximately 296753.19 sq. ft. It is collected in two tanks of 11000 ltr and 24000 ltr capacity each.</li> </ul>	
	<ul style="list-style-type: none"> <li>Map of the Rain Water Harvesting Mechanism</li> </ul>	
	<ul style="list-style-type: none"> <li>Geo-tagged photographs</li> <li>Registrar's Certificate</li> </ul>	
2	<b>Borewell / Open well recharge</b>	
	<ul style="list-style-type: none"> <li>Description : University has two open wells and Borewells to fulfill its drinking water needs.</li> </ul>	
	<ul style="list-style-type: none"> <li>Purchase bill of the electric motor of borewell along with copy of stock register</li> </ul>	
	<ul style="list-style-type: none"> <li>Vouchers for payment made to different vendors for cleaning and recharge of open wells</li> </ul>	
	<ul style="list-style-type: none"> <li>Geo-tagged photographs</li> <li>Registrar's Certificate</li> </ul>	
3	<b>Construction of Tanks and Bunds</b>	
	<ul style="list-style-type: none"> <li>Description : There is a natural water stream bund near the boundary of the university. Its water helps for well recharge and groundwater level recharge . Two underground water tanks are available to store water, from where water is lifted up to fill tanks at building roof tops for distribution.</li> </ul>	
	<ul style="list-style-type: none"> <li>Geo-tagged photographs</li> <li>Registrar's Certificate</li> </ul>	
4	<b>Waste Water Recycling</b>	
	<ul style="list-style-type: none"> <li>Description : The University has Sewage Treatment Plant of 100 kilo-ltr per day where all the waste water from all blocks is treated and used for gardening and in agriculture farm of the university.</li> </ul>	
	<ul style="list-style-type: none"> <li>Bill for Purchase and Technical Details of Sewage Treatment Plant</li> </ul>	
	<ul style="list-style-type: none"> <li>Bills for maintenance of Waste Water Recycling System</li> <li>Geo-tagged photographs</li> </ul>	
5	<b>Maintenance of water bodies and distribution system in the campus</b>	
	<ul style="list-style-type: none"> <li>Description : The ground water is pumped into storage tanks located at different places in the campus. There are nine major over head storage tanks and many block wise plastic tanks for water distribution in the campus. The water is distributed through well laid pipe network.</li> </ul>	
	<ul style="list-style-type: none"> <li>Map of Water Distribution System at University</li> </ul>	
	<ul style="list-style-type: none"> <li>Bills, Vouchers &amp; Stock Entries relating to upkeep of water distribution System</li> </ul>	
	<ul style="list-style-type: none"> <li>Registrar's certificate</li> <li>Geo-tagged photographs</li> </ul>	



#### **7.1.4 Rain Water Harvesting-*Documents Attached***

1. Map of the Rain Water Harvesting Mechanism
2. Registrar's Certificate



3.0M

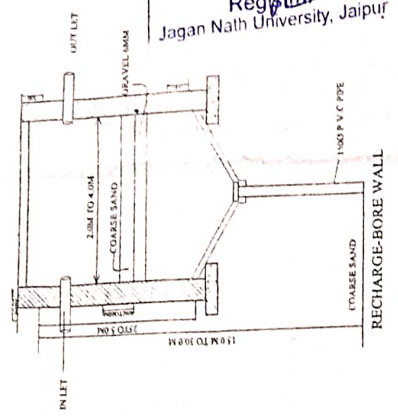
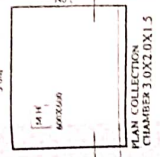

Certified True Copy  
Registrar  
Jagan Nath University, Jaipur

**AREA CHART WATER HARVESTING**

**BLOCK NO. I**  
AREA OF ROOF TOP CATCHMENT (A) = 184.38 SQ.M  
PEAK RAIN FALL IN 15 MINUTES (A) = 25.50 MM (2.55 CM)  
CAPACITY OF FILLERATION TANK (A) = 4700 LITRE  
REQUIRED INFLUX (A) = 4700 LITRE = 4.70 CU.M  
PROPOSED FILTRATION TANK (A) = 1.50x3.00x1.50 = 6.75 CU.M

**BLOCK NO. II**  
AREA OF ROOF TOP CATCHMENT (A) = 126.38 SQ.M  
PEAK RAIN FALL IN 15 MINUTES (A) = 25.50 MM (2.55 CM)  
CAPACITY OF FILLERATION TANK (A) = 3200 LITRE  
REQUIRED INFLUX (A) = 3200 LITRE = 3.20 CU.M  
PROPOSED FILTRATION TANK (A) = 1.50x2.00x1.50 = 4.50 CU.M

**BLOCK NO. III**  
AREA OF ROOF TOP CATCHMENT (A) = 254.38 SQ.M  
PEAK RAIN FALL IN 15 MINUTES (A) = 25.50 MM (2.55 CM)  
CAPACITY OF FILLERATION TANK (A) = 6400 LITRE  
REQUIRED INFLUX (A) = 6400 LITRE = 6.40 CU.M  
PROPOSED FILTRATION TANK (A) = 1.50x4.00x1.50 = 9.00 CU.M

**Block No. I**  
AREA OF ROOF TOP CATCHMENT (A) = 184.38 SQ.M  
PEAK RAIN FALL IN 15 MINUTES (A) = 25.50 MM (2.55 CM)  
CAPACITY OF FILLERATION TANK (A) = 4700 LITRE  
REQUIRED INFLUX (A) = 4700 LITRE = 4.70 CU.M  
PROPOSED FILTRATION TANK (A) = 1.50x3.00x1.50 = 6.75 CU.M

**Block No. II**  
AREA OF ROOF TOP CATCHMENT (A) = 126.38 SQ.M  
PEAK RAIN FALL IN 15 MINUTES (A) = 25.50 MM (2.55 CM)  
CAPACITY OF FILLERATION TANK (A) = 3200 LITRE  
REQUIRED INFLUX (A) = 3200 LITRE = 3.20 CU.M  
PROPOSED FILTRATION TANK (A) = 1.50x2.00x1.50 = 4.50 CU.M

**Block No. III**  
AREA OF ROOF TOP CATCHMENT (A) = 254.38 SQ.M  
PEAK RAIN FALL IN 15 MINUTES (A) = 25.50 MM (2.55 CM)  
CAPACITY OF FILLERATION TANK (A) = 6400 LITRE  
REQUIRED INFLUX (A) = 6400 LITRE = 6.40 CU.M  
PROPOSED FILTRATION TANK (A) = 1.50x4.00x1.50 = 9.00 CU.M

Approved Education Institute at Vignani No. 842, 843, 844, 845, 846, 847, 848, 849, 850, 851, 852, 853, 854, 855, 856, 857, 858, 859, 860, 861, 862, 863, 864, 865, 866, 867, 868, 869, 870, 871, 872, 873, 874, 875, 876, 877, 878, 879, 880, 881, 882, 883, 884, 885, 886, 887, 888, 889, 890, 891, 892, 893, 894, 895, 896, 897, 898, 899, 900, 901, 902, 903, 904, 905, 906, 907, 908, 909, 910, 911, 912, 913, 914, 915, 916, 917, 918, 919, 920, 921, 922, 923, 924, 925, 926, 927, 928, 929, 930, 931, 932, 933, 934, 935, 936, 937, 938, 939, 940, 941, 942, 943, 944, 945, 946, 947, 948, 949, 950, 951, 952, 953, 954, 955, 956, 957, 958, 959, 960, 961, 962, 963, 964, 965, 966, 967, 968, 969, 970, 971, 972, 973, 974, 975, 976, 977, 978, 979, 980, 981, 982, 983, 984, 985, 986, 987, 988, 989, 990, 991, 992, 993, 994, 995, 996, 997, 998, 999, 1000.

**WATER HARVESTING PLAN**

DRAWN BY: *[Signature]* DELEG. NO. P-6  
 CHECKED BY: SANJAY  
 DATE: 19-08-2007  
 SCALE: 1:100

THE ARCHITECT: *[Signature]* Owner  
 Architect: 715293

CONSULTANT: *[Signature]*  
 VIVEK KHANNA & ASSOCIATES  
 417, Kirti Park, Jaipur  
 Ph: 27770000, 27770001, 27770002, 27770003, 27770004, 27770005, 27770006, 27770007, 27770008, 27770009, 27770010

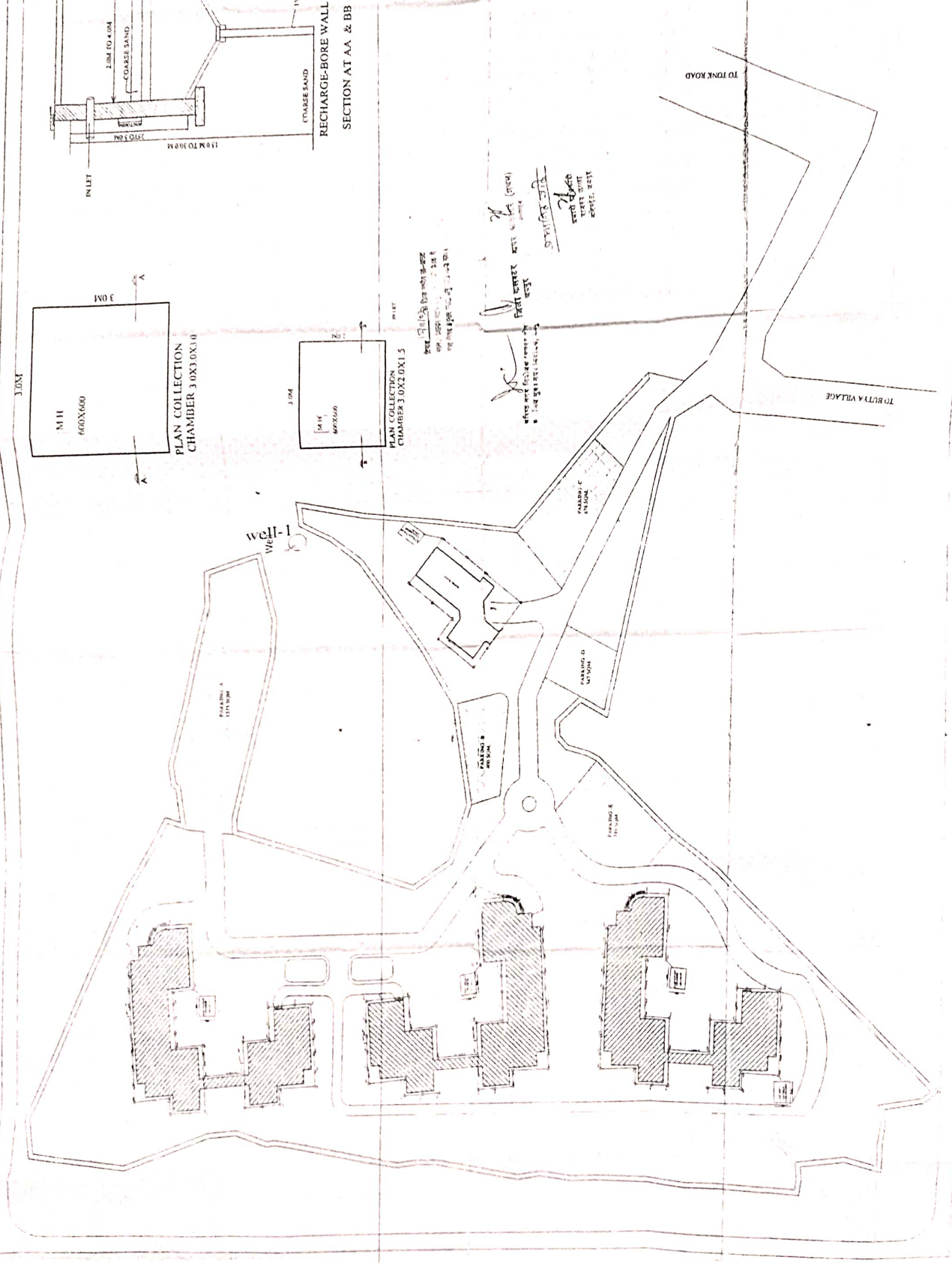

STY/AR/11/11  
 19/08/07  
 19/08/07  
 19/08/07



Date:- 2 Feb. 2022

**TO WHOMSOEVER IT MAY CONCERN**

This is to certify that the **Rain Water Harvesting System** constructed at Jagan Nath University, Jaipur was constructed as a part of a larger construction project carried out by the University during the construction work carried out from 2008 onwards from time to time. The University has been carrying out civil work for maintenance through its internal maintenance cell.

  
**Registrar**  
**Registrar**  
Jagan Nath University  
Jaipur



Date:- 2 Feb. 2022

**TO WHOMSOEVER IT MAY CONCERN**

This is to certify that a **Manmade Lake For RainWater Storage and Usage** at Jagan Nath University, Jaipur was constructed while other major civil work were being carried out in the campus. The cost of labour and material utilized in the same was covered in the consolidated for all projects together.

**Registrar**

**Registrar**  
Jagan Nath University  
Jaipur





**JAGANNATH**  
UNIVERSITY

NAAC Accredited Grade 'B' (Good)

University Campus : Village Rampura, Tehsil Chaksu, Jaipur

Ph.: 0141-3020500-555, 4071551-552 Fax No. 0141-3020538

(Under the aegis of Jagannath Gupta Memorial Educational Society)

**CASH/BANK JOURNAL VOUCHER**

Date : 7/8/2018

PARTICULARS	CODE	DEBIT		CREDIT	
		Rs.	P.	Rs.	P.
Repair & Ments B/d		40825			
To Khandeewal Saintry & Hardware				40825	
(Being Amt credited to m/s Khandeewal Saintry & Hardware) Aged Bill No 916 dt 31/7/18 for New Motor Purchase & Pipe & fitting for well					
		40825		40,825	

Prepared By

*[Signature]*

Received by

Authorised Signatory

Certified True Copy  
Registrar  
Jagan Nath University, Jaipur

*[Signature]*  
Accounts Officer  
JAGANNATH UNIVERSITY  
JAIPUR



GSTIN No.08AEYPG2195J1ZU  
CASH /CREDIT MEMO



॥ श्री गणेशाय नमः ॥  
GST INVOICE



Mob. 9414311585

# खण्डेलवाल सैनेट्री एण्ड हार्डवेयर (गरुड़वासी वाले)

अधिकृत विक्रेता :- "किसान" एवं "के-विंग," पी. वी. सी. पाइप "सेमीकोन", "गंगा", वाटर टैंक, "प्लूगा", "जी.एम.सी." एवं "उन्नति" सबमसिल पम्पस, सैनेट्री फिटिंग, जी. आई. फिटिंग, पी.वी.सी. पाइप एवं फिटिंग फव्वारा पाइप एवं फिटिंग इलेक्ट्रीक पम्प व हार्डवेयर के विक्रेता  
बैंक ऑफ बडोदा के पास, टोंक रोड, चाकसू (जयपुर)

Pink Original, White Duplicate

Mr./Ms. JAGANNATH UNIVERSITY Invoice No. 918 Date 31.07.18  
Address Rampura Transporter \_\_\_\_\_  
GSTIN \_\_\_\_\_  
PAN/ADHAR MP2 PS 28 State: Rajasthan Code : 08

S. No.	PARTICULARS	HSN CODE	Qty.	Rate	Taxable Amt.	CGST		SGST		Total Amount
						Rate	Amt.	Rate	Amt.	
1	Sellinbe pump 578 T.P. unndi.		1	2364	2364	6%	141.9	6%	141.9	2650/32
2	Pannery SHP		1	3500	3500	9%	315	9%	315	4130/-
3	Cast 4mm		37	59	2184	9%	197	9%	197	2589/90
4	Cast 18mm		110	80	880	9%	80	9%	80	
5	11206/11206 2"		110	71	7810	6%	468.6	6%	468.6	1319.46
6	Camp 2mm clip		1	2121	2121	9%	190.89	9%	190.89	4949/26
7	Gum 249 GIMPH		4	125	500	9%	45	9%	45	250/16
8	Frame 24 flanch		4	80	320	9%	288	9%	288	590/-
9	Cast - Belt		10	10	100	9%	9	9%	9	377/66
<b>TOTAL</b>										<b>40824/70</b>

Our Bank Detail : Bank of Baroda Chaksu  
A/c no. 34470400000109 IFSC Code-BARBOCHAKSU

TOTAL TAXABLE AMOUNT	35860/20
TOTAL GST	4964/46
G.TOTAL	40824/70

Rupees in words: 40824/-

01 AUG 2018  
1. भूल-चूक लेनी देनी।  
2. बिका हुआ माल वापस नहीं होगा।  
3. सभी विवादों का न्याय क्षेत्र जयपुर होगा।  
उन्नति पम्प सेमीकोन किसान पाइप  
Jagan Nath University  
Campus Jaipur  
Inward/Outward  
153  
Jagan Nath University Jaipur

Certified True Copy

Registrar  
Jagan Nath University, Jaipur

Accounts Officer  
JAGANNATH UNIVERSITY  
JAIPUR



mkd

128

# Stock Entry

date	Bill	Particulars	Qty	Amnt	Remark
7/18	918	Khandelwal Sanitary & Hoac			
		Submeasible Pump SHPunnah	01	28500/-	12% tax paid
		Pannel SHP	01	4130/-	18% Paid
		Cable 4 core 37metr @ 71/-	37	2589/-	18% Paid
		Rope @ 10.71 + tax	110lt	1319.	18%
		Hose Pipe Black @ 38.13 + tax	110lt	4949	18%
		Clip 20" @ 212 + tax	01	250	18%
		GI Nipple @ 125 + tax	04	590	18%
		flunch @ 80 + tax	04	377	18%
		Bolt @ 10 x 10 + tax		1181-	18%
				<u>40824/-</u>	

17/Nov/18 Afo MR 6071 - 9235 = 3164  
 17/Nov/18 2708  
 3164 + 2708 = 5872 @ 8.35 49031.20 Paid -  
 21/Nov/18 ~~MR 5342 = 2634 @ 8.35 = 21994~~  
 03/Apr/19 6754 unit 4046 @ 8.35 33784/-  
 march Rent 2019 12500/-  
 Ch-NO 005412 46284/- 31/march

29/may/19 Sitaran Meena  
 Rented well cable  
 fixing 1000 metr @ 30/- 30000/-

29/10/21 239 21575 5715 67A  
 Cate parts motor winding S.H.P  
 1614 through Bearing  
 oil seal  
 stat bolt  
 21575 5715 67A रिपैरि

Certified True Copy  
 Registrar  
 Jagan Nath University, Jaipur  
 2570  
 480  
 160  
 320  
3460



TIN : 08852162506

VAT INVOICE

Phone : 3267911, 2390476  
Cell.: 94146-06037  
E-mail : guptapipe150nam@yahoo.

# GUPTA PIPE & FITTING STORE

150, New Atish Market, Gopal Pura Bye-Pass Road, Jaipur - 302 020

JAGANNATH UNIVERSITY EXPENDITURE  
JAIPUR



Bill No. : 781  
Dated : 26/06/2010  
our ref : 781

Party TIN No

S.No.	Item Code	Particulars	Quantity	Rate	Disc	Net Amount
1	OTHERS	150 MM MS STEEL TUBE	5.00PCS	4,423.08		22,115.40
2	SC	SLOTING CHARGES	2.00PCS	400.00		800.00

*stock Regd. No - 191*

*M.S. Pipe for Rain water harvesting bore recharge well*

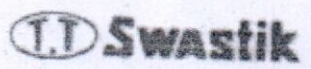
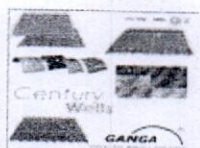

*100' Pipe @ 230/- Per Ft.*

Gross Total :	22,915.40
VAT 4%	916.62
FREIGHT ON SALE	800.00
Round off	-0.02
<b>Total :</b>	<b>24,632.00</b>

Rupees Twenty Four Thousand Six Hundred Thirty Two Only

Transporter Name :  
R.R./T.R. No. :  
Despatch Date :  
Cases :

Despatch Document Through :  
Freight Type :  
Freight Amount :

Certified True Copy  
Registrar  
Jagan Nath University, Jaipur

\* Interest will be charged @24% p.a. after 1 month.  
\* Claims for discrepancies, if any, must be made within 7 days after receipt of goods positively otherwise no claims will be entertained.  
\* All disputes subject to Local Jurisdiction only.

For GUPTA PIPE & FITTING STORE

*(Signature)*  
(Authorized Signatory)



TIN : 08852162506

// श्री गणेशाय नमः //



Delivery Challan Cum Perfoma Invoice

(Offi.) : 0141-2390476  
(Resi.) : 0141-2670663  
Girraj : 94146-06037  
Ganesh : 93147-55363

# Gupta Pipe & Fitting Store

DEALS IN : Ambuja, RTL, (TT) Swastik, (TTT) Rama Jindal Hissar Pipes,  
Charminar ACC Sheets, Jindal, Tata Iron Sheets, PVC Pipes, Steel Garder Channel  
& Angles. Submersible Pumps & Water Pumps

150, New Atish Market, Gopalpura Bye-pass Road, Mansarovar, Jaipur - 302 020

Ms. <u>Jaggannath University</u> <u>JAIPUR</u>	Challan No. <u>781</u>	Dt. <u>28/06/10</u>
TIN No. ....	Transport Through.....	Ex Jaipur to..... Truck No.....
	Private Mark.....	Weight.....

S. No.	SIZE	PARTICULARS	Pcs.	MTRS. M. Tons	RATE	APPROX VALUE Rs.
	150MM	MS Black Steel Tube (3+2)	5			Jaggannath University Gopalpura, Chaksu JAIPUR Inward/Outward
		Vat 4% Extra				26 JUN 2010
					SP No. ....	
Approximate Value Rs. ....						Date .....

- Received the above goods in good condition.
- Subject to Jaipur Jurisdiction
- Good once sold will not be taken back.
- Payment should be made within 7 days otherwise interest @ 24% will be charged from date of Invoice.

Receiver's Signature

For GUPTA PIPE &amp; FITTING STORE

Signature

Certified True Copy  
Registrar  
Jagan Nath University, Jaipur



## ESTIMATE OF RAIN WATER HARVESTING

Item No.	DESCRIPTION	Unit	Qty.	Full Rate	Amount	Remarks
1	2	3	6	10	12	
1	Excavation in foundation for rain water harvesting	Cum	120.802	85.00	10268.15	
3	Providing & laying PCC (1 : 4 : 8)	Cum	1.730	2200.00	3805.68	
4	Brick work in cement mortal (1 : 6)	Cum	26.382	2400.00	63317.92	
5(i)	Providing and laying M-20 Grade concrete machine	Cum	3.651	3300.00	12048.86	
6	Center, shuttering with good quality ply/ steel	Sqm	28.384	160.00	4541.50	
7	Laying Reinforcement steel	MT	0.360	4000.00	1438.47	
8	15 mm th smooth plaster in mortar (1 : 6)	Sqm	97.552	80.00	7804.16	
9	Providing and filling boulders of size 40 mm	Cum	0.000	L/S	1000.00	
10	Providing and filling gravels of size 5-10 mm	Cum	0.883	L/S	2000.00	
11	Providing and filling Coarse sand of size 1.5-2.00 mm	Cum	1.329	L/S	1000.00	
12	DRILLING IN ALL KIND OF SOIL / HARD ROCK	Rmt	100.000	130.00	13000.00	
13	PERFORATED M.S.PIPE FOR CASING OF SIZE 5" DIA	RFT	100.000	230.00	23000.00	
14	PROVIDING AND FILLING PEA GRAVEL	Cum	1.617	1250.00	2021.32	
15	Making and fixing M.S.foot rest	Nos	10.000	100.00	1000.00	
16	Shifting and laying of SS RCC NP2 pipes of required dia in trenches	Rmt	6.000	300.00	1800.00	
					148046.08	

Certified True Copy  
 Registrar  
 Jagannath University, Jaipur

10-6-10